

## Hondo Nuevo Plinth Base Assembly Instructions

### Model Number

HN800-YYY, HN850-800-ZZZB  
 HN805L-YYY, HN850-800-ZZZB  
 HN805R-YYY, HN850-800-ZZZB  
 HN810-YYY, HN850-800-ZZZB  
 HN815-YYY, HN850-800-ZZZB  
 HN820-YYY, HN850-820-ZZZB  
 HN825-YYY, HN850-825-ZZZB  
 HN830-YYY, HN850-830-ZZZB  
 HN835-YYY, HN850-835-ZZZB  
 HN845-YYY, HN850-845-ZZZB  
 HN880-YYY, HN850-800-ZZZB  
 HN885-YYY, HN850-885-ZZZB

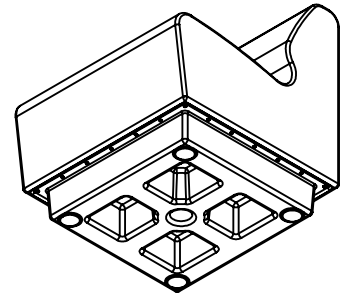

**Assembly Notes:** Norix is not responsible for any damage due to improper installation. If your shipment does not match the parts list, please contact Norix Customer Service at 800-234-4900.  
 Norix reserves the right to modify design specifications at any time without an obligation to owners of previously sold products.

### Parts List

ITEM	QTY.	PART NUMBER	DESCRIPTION
A	24	021-166	Screw, Sheet Metal, #10-16 X 1 L, BH, Pin in Torx T-25, Blk. Ox

### Tools Needed

Low RPM Variable Speed Drill  
 Pin in Torx Bit, T-25

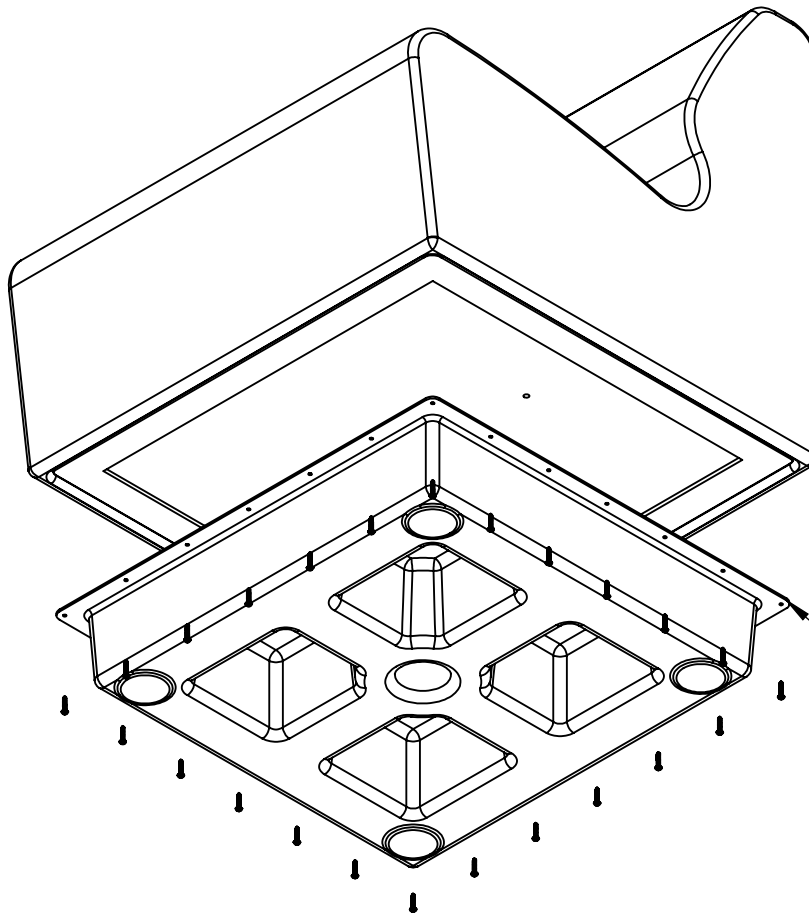

SECURE PLINTH BASE  
 USING SCREWS AT  
 DIMPLED LOCATIONS.